



P.O. Box 1719  
 Corona, CA 92878  
 Support: 951-493-7100  
 www.aFeFilters.com

# Intake Kit Installation Instructions: '03-'06 Ford F-Series Super Duty/ Excursion V8-6.0L (td)

<b>Kit Part #</b>	51/54-11022/ 75-11022		<b>Tools Required:</b>	<b>Part List: Stage 2 (cont.)</b>	<b>Part List: Stage 2 (cont.)</b>
<b>Make:</b>	Ford		5/16" nut driver or slotted screwdriver	1 Bracket, Battery Cable Support	1 Grommet, Rubber MS35489-52
<b>Model</b>	<b>Year</b>	<b>Engine</b>	10mm socket or wrench	1 Tube, Rotomold	1 Grommet, Rubber MS35489-22
F250	'03-'06	V8-6.0L (td)	Ratchet and extension	1 Tube, Rotomold	2 Screw, Hex Head 5/16-18
F350	'03-'06	V8-6.0L (td)	13mm socket or wrench	4 Clamp #64	1 Gasket Mass sensor
Excursion	'03-'06	V8-6.0L (td)		1 Washer M6x13 Nut M6x1	2 Spacer, Nylon: 1/20Dx1/4IDx1/8L
			<b>Part List: Stage 2</b>	3 Nut, M6x1	2 Screw, 8-32x5/8"
			1 Air filter Replacement P/N ( 24-91036, <b>Pro Dry S</b>	2 Washer Wavy M6	1 Torq Bit
			21-90041 or <b>Pro GUARD 7</b> 72-90041)	2 Screw, Hex Head, M6x1x25	31 Seal, Trim
			1 Filter Housing	1 Coupling , Straight, 4"Dx2-1/2"L (Hi-Temp)	1 Grommet, Rubber: MS35485-73
			1 Bracket, Battery hold down	1 Coupling , Hump, 4"Dx3"L	1 Battery, pad urethane



**Step 1**  
 Complete kit. Make sure you have all the components before you begin your installation.



**Step 2**  
 Complete stock intake.

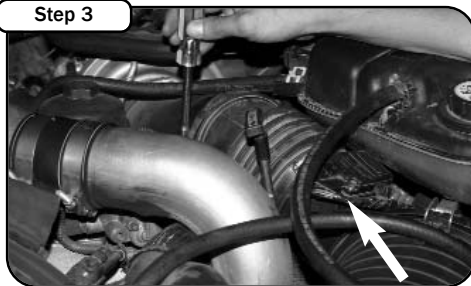

**Step 3**  
 Loosen the hose clamp on the turbo inlet. Carefully disconnect the MAF sensor wiring harness.

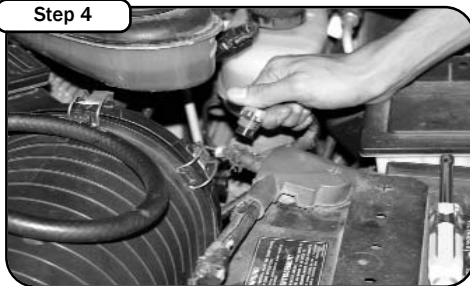

**Step 4**  
 Disconnect the Filter Minder located on the back of the air filter box.

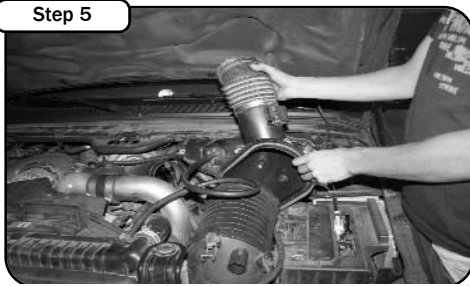

**Step 5**  
 Undo the two retaining clips securing the air box outlet. Lift up and remove the turbo inlet tube and filter lid as one piece.



**Step 6**  
 Remove the inlet portion of the air box out of the engine bay.



**Step 7**  
 Disconnect passenger side battery terminals, remove battery cover and battery from engine compartment.

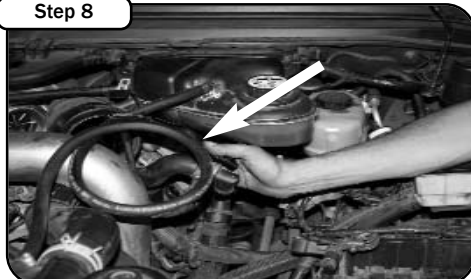

**Step 8**  
 Using a 10mm socket or wrench remove tube support bracket from engine. Loosen clamp at turbo with a 5/16 nut driver or screwdriver.



**Step 9**  
 Using a 13mm socket or wrench Remove all screws holding the battery tray in the vehicle.



**Step 10**  
 Remove battery tray support bracket from vehicle using a 13mm socket or wrench.

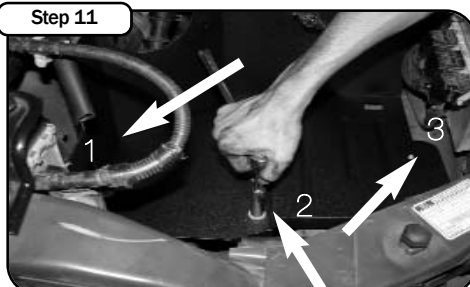

**Step 11**  
 Install trim seal onto housing and install housing. 1. Use supplied 6mm washer and nut. 2. Re-use factory screws (2x) 3. Re-use factory screws (1x)



**Step 12**  
 Install rubber grommet onto housing. With both batteries disconnected remove wire from terminal using a 10mm socket and pull wire through housing and reconnect.



**Step 13**  
 1. Remove crank case breather from factory tube. 2. Place rubber grommet into hole and press crank case breather into grommet on tube.

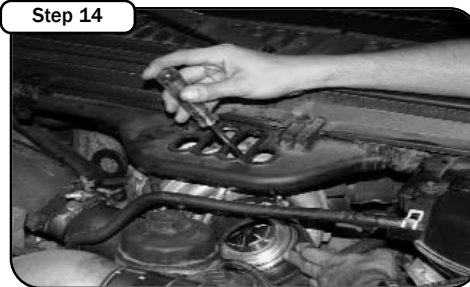

**Step 14**  
 Install grey high temp silicon coupling onto turbo. Tighten clamp at turbo.

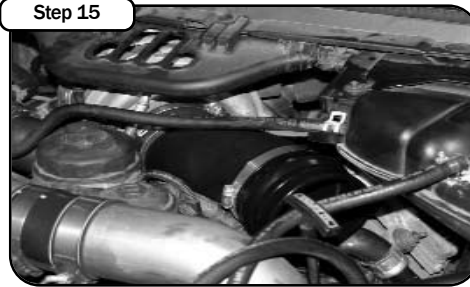

**Step 15**  
 Slide tube onto coupler and reconnect crank case breather. Install hump coupler onto end of tube.

Note: Filter Cleaning and Re-oiling: When cleaning your aFe filter, be sure to use only aFe's "Restore Kit" (aFe P/N: 90-50001 blue oil aerosol, or aFe P/N: 90-50501 blue squeeze bottle oil or aFe P/N: 90-50000 gold oil aerosol, or aFe P/N: 90-50500 gold squeeze oil).  
 Filter Replacement: Magnum FLOW PN: 24-91036 (black w/blue media), or Pro-GUARD 7™ PN: 72-90041 (black w/gold media), **Pro Dry S** 21-90041 (black w/white media) **Pro Dry S** cleaning: see cleaning instructions 06-00074



P.O. Box 1719  
 Corona, CA 92878  
 Support: 951-493-7100  
 www.aFeFilters.com

# Intake Kit Installation Instructions: '03-'06 Ford F-Series Super Duty/ Excursion V8-6.0L (td)

<b>Kit Part #</b> 51/54-11022/ 75-11022	<b>Tools Required:</b> 5/16" nut driver or slotted screwdriver 10mm socket or wrench Ratchet and extension 13mm socket or wrench	<b>Part List: Stage 2</b> 1 Air filter Replacement P/N ( 24-91036, Pro Dry S 21-90041 or Pro GUARD 7 72-90041) 1 Filter Housing 1 Bracket, Battery hold down 1 Bracket, Battery Cable Support 1 Tube, Rotomold 1 Tube, Rotomold 4 Clamp #64 1 Washer M6x13 Nut M6x1 <b>3 Nut, M6x1</b>	2 Washer Wavy M6 2 Screw, Hex Head, M6x1x25 1 Coupling , Straight, 4"Dx2-1/2"L (Hi-Temp) 1 Coupling , Hump, 4"Dx3"L 1 Grommet, Rubber MS35489-52 1 Grommet, Rubber MS35489-22 2 Screw, Hex Head 5/16-18 1 Gasket Mass sensor 2 Spacer, Nylon: 1/2ODx1/4IDx1/8L 2 Screw, 8-32x5/8" 1 Torq Bit Seal, Trim 1 <b>Grommet, Rubber: MS35485-73</b> 1 <b>Pad, urethane</b>
<b>Make:</b> Ford			
<b>Model</b> <b>Year</b> <b>Engine</b>			
F250    '03-'06    V8-6.0L (td)			
F350    '03-'06    V8-6.0L (td)			
Excursion    '03-'06    V8-6.0L (td)			

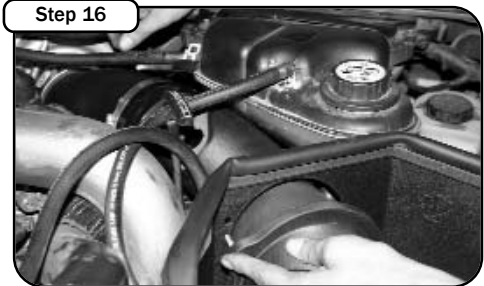

**Step 16**  
 Install tube and mount to housing using hardware provided. Tighten hump coupler where the two tubes meet.

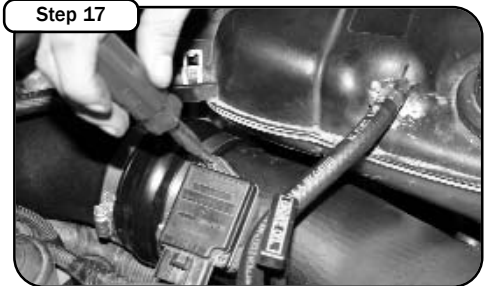

**Step 17**  
 Remove mass sensor and filter minder gasket from factory housing. Install sensor onto tube using gasket, spacers and screws supplied. Install filter minder onto tube. Use factory rubber grommet.

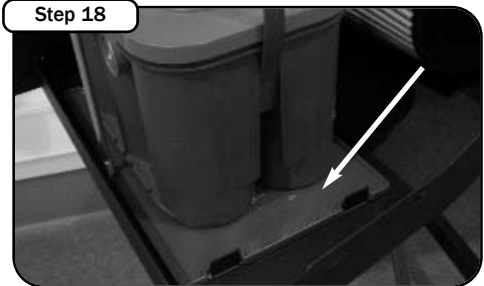

**Step 18**  
 Install battery pad to housing, Sandwich battery cable support bracket and connect tab to plastic push pin on cable.



**Step 19**  
 Install filter onto tube. Tighten clamp.



**Step 20**  
 Your installation is now complete. Make sure you tighten all clamps and check all electrical connections. Re-check periodically.

Note: Filter Cleaning and Re-oiling: When cleaning your aFe filter, be sure to use only aFe's "Restore Kit" (aFe P/N: 90-50001 blue oil aerosol, or aFe P/N: 90-50501 blue squeeze bottle oil or aFe P/N: 90-50000 gold oil aerosol, or aFe P/N: 90-50500 gold squeeze oil).  
 Filter Replacement: Magnum FLOW PN: 24-91036 (black w/ blue media), or Pro-GUARD 7™ PN: 72-90041 (black w/ gold media), Pro Dry S 21-90041 (black w/ white media) Pro Dry S cleaning: see cleaning instructions 06-00074