



# INSTALLATION INSTRUCTIONS

Cat-Back Exhaust

**MAKE:** Ford  
**MODEL:** Ranger  
**YEAR:** 2019-2022  
**ENGINE:** L4-2.3L (t)

49-43115-B  
49-43115-P

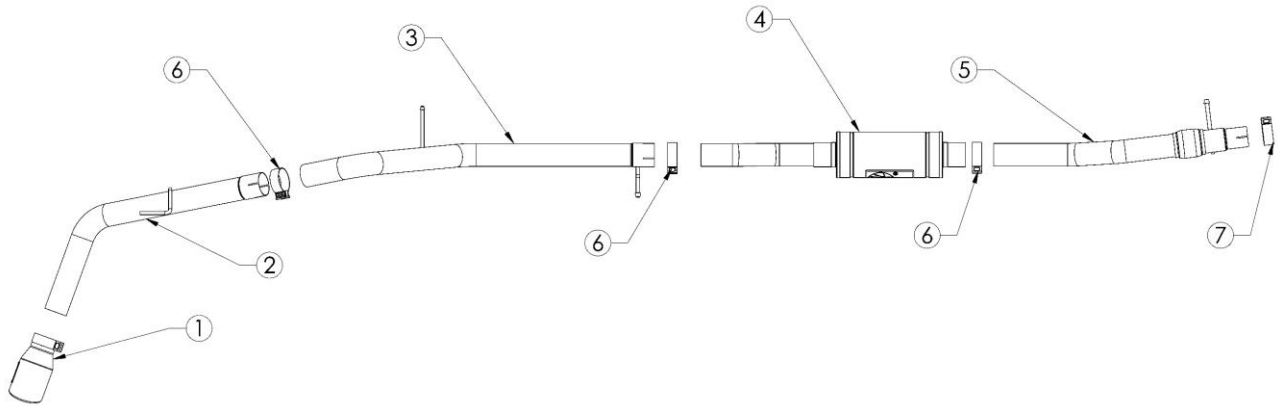

Item	Description	Part Number	Quantity
1	3" 409 SS Exhaust Tip (Black)	49T30451-B09	1
1	3" 409 SS Exhaust Tip (Polished)	49T30451-P09	1
2	Tail Pipe Assembly	05-144710	1
3	Over-Axle Assembly	05-144711	1
4	Muffler Assembly	05-144681	1
5	Mid Pipe Assembly	05-144680	1
6	Clamp, Band: 3"	05-41055	3
7	Clamp, Band: 2-1/2"	05-41061	1

aFe POWER recommends professional installation on this product. Thoroughly inspect the aFe POWER exhaust system to make sure there is no damage from shipping (if damage is noted, immediately contact aFe POWER customer service). Allow time for your vehicle to cool down prior to installation. When working on your vehicle proceed with caution. Wear protective safety equipment; eye goggles and gloves to ensure a safe installation.

Install band clamps to proper torque specifications of 40-45 ft-lb.





## INSTALLATION INSTRUCTIONS

Cat-Back Exhaust

**MAKE:** Ford  
**MODEL:** Ranger  
**YEAR:** 2019-2022  
**ENGINE:** L4-2.3L (t)

49-43115-B  
49-43115-P

1. **(Read instructions prior to installation.)** It is recommended to not fully tighten the exhaust until it has been fully installed. Leave loose for adjustability.
2. Secure vehicle on jack stands (refer to your manual for specified jack stand positions).
3. For faster installation, spread out the parts of the exhaust alongside your vehicle as shown in the diagram.
4. Secure the stock exhaust with jack/stands.
5. Remove the O.E. muffler at the clamped joint located at the front of the muffler.
6. Remove the O.E. mid pipe section located at the next clamp joint
7. Install the front pipe using the (x1) supplied 2.5" band clamp and O.E. isolation mount.
8. Install the muffler assembly using the (x1) supplied 3" band clamp and O.E. isolation mount.
9. Install the over-axle pipe using the (x1) supplied 3" band clamp and O.E. isolation mount.
10. Install the tail pipe and tip using the (x1) supplied 3" band clamp and O.E. isolation mount.
11. Adjust tip to desired position.
12. Ensure that all the components of the aFe POWER exhaust system are aligned and are at a safe clearance from all wires, hoses, brake lines, body parts, and tires.
13. Start from the front of the aFe POWER exhaust system and evenly tighten all clamps and fasteners.
14. Start the vehicle and check for any leaks. If any leaks are found, determine cause and repair as necessary.
15. Remove vehicle from jacks stands.
16. It is recommended to re-tighten all clamps and hardware after 50-100 miles.