



advanced FLOW engineering™
252 Granite St. Corona, CA
92879
Support: 951-493-7100
afepower.com

Intake Kit Installation Instructions: Golf/Jetta 2009-2015 L4-2.0L TDI

Kit Part # 61-66-01711 75-01741 75-01711-01 Value Pack	Stage 1	Tools Required: 5/16" nut driver or slotted screwdriver Phillips screwdriver 1/2" open end wrench Medium size pliers	Part List: 1 Air Filter Pro-SR™ 24-35507 Pro Dry S™ 21-35507 or Pro GUARD 7™ 72-35507 1 Tube, Intake 1 Cover 1 Coupling (05-00664) 2 Clamp #048 4 Screws, 1-1/2" 1 Trim, Rubber 21 25" 1 Nipple, Brass 1/4" x 1/8" NPT	Value Pack Includes: 1 Prefilter 1 Pro GUARD 7™ Resistor Kit 1 Pro Dry S™ Air Filter
--	----------------	---	--	--



Complete stock intake.

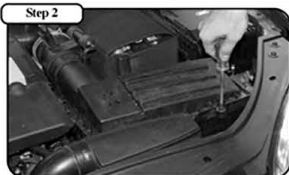

Remove the (8) screws holding the stock cover to the housing.



Disconnect the MAF sensor and unplug the breather tube that are located on the top side of the stock intake tube.



With a pair of pliers, loosen the clamp holding the MAF sensor to the stock intake tube and remove the cover and sensor from the vehicle.



Remove the stock air filter and plastic grill from the factory air box.

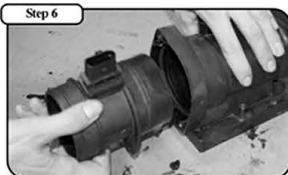

Using a phillips screwdriver, remove the MAF sensor from the stock cover.



Re-insert the MAF sensor into the stock intake tube.



Insert the afE intake tube along with the coupling and clamps onto the MAF sensor. Secure the intake tube using the provided screws.

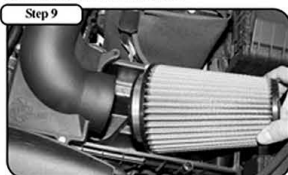

Install the afE air filter onto the afE intake tube.

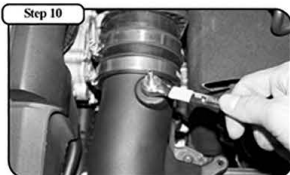

Tighten the Brass Nipple using either a box wrench or a deep socket.



Push the breather tube onto the brass nipple. The special fitting does not require a clamp.



Tighten all clamps.



Place trim seal on the bottom side of the intake cover.



Secure the cover to the housing by tightening two of the stock screws using a phillips screwdriver. Use one of the screws provided for the tab that sits on the intake tube.



Your Stage 1 Intake is now complete. Make sure to tighten all clamps and check all electrical connections. Re-tighten clamps after a few hours of Operation. Thank you for choosing afE Power!

Note: Filter Cleaning and Re-oiling: When cleaning your afE filter, be sure to use only afE's "Resistor Kit" (afE P/N 90-50001) blue oil aerosol, afE P/N: 90-50501 blue squeeze bottle oil, afE P/N: 90-50500 Pro GUARD 7™ gold squeeze bottle oil, or afE 90-50000 gold aerosol oil
Filter Replacement: Magnum FLOW P/N: Pro-SR™ #24-35507 (black w/ blue media) or Pro Dry S™ #21-35507 (black w/ white media) or Pro GUARD 7™ #72-35507 (black with gold media)